

LINE 118: FORT IRWIN - HESPERIA

SOUTHBOUND

From Fort Irwin Bus Lot

- | | |
|--|--|
| (L) 2nd St | (R) L St exit |
| (R) South Loop Rd | (R) L St |
| (L) Langford Lake Rd | (R) into Park & Ride |
| (R) Mates | circle left inside of Park & Ride |
| (L) South Depot Loop | Perimeter |
| into Inner Loop Rd | (L) L St |
| (L) 5th St | (R) 15 Freeway South |
| (R) Outer Loop Rd | (R) D St/Highway 18 exit |
| (R) Barstow Rd | (R) D St/Highway 18 |
| (L) 5th St | (L) 4th St |
| (R) South Loop Rd | into VVTC |
| (R) North Loop Rd | circle around to last stop before exit |
| (R) Barstow Rd | (R) D St |
| (R) into Child Development Center | (L) 15 Freeway South |
| Loop counterclockwise in parking lot | (R) La Mesa Rd/Nisqualli Rd exit |
| (L) Barstow Rd | (L) Amargosa Rd |
| (L) North Loop Rd | (L) into Bear Valley Park & Ride |
| (R) South Loop Rd | circle around to exit |
| (R) into Irwin Rd | (R) Amargosa Rd |
| stop across from Mt View Cemetery | (R) Bear Valley Rd |
| continue on Irwin Rd | (R) 7th Ave |
| (R) 1st Ave | (L) Main St |
| (L) Main St | (L) E Ave |
| (R) Barstow Rd | (R) Smoke Tree St |
| (R) Williams | (L) Hesperia Division driveway |
| to stop by parking lot | |
| (L) 2nd Ave | |
| (L) Buena Vista St | |
| (R) Barstow Rd | |
| (L) 15 Freeway North | |
| (R) 40 Freeway | |
| (R) Montara Rd exit | |
| (R) Montara Rd | |
| (R) into Montara Elementary School lot | |
| circle through lot | |
| (L) Montara Rd | |
| to Walmart bus stop | |
| (L) 40 Freeway | |
| Into 15 Freeway South | |

LINE 118: FORT IRWIN - HESPERIA

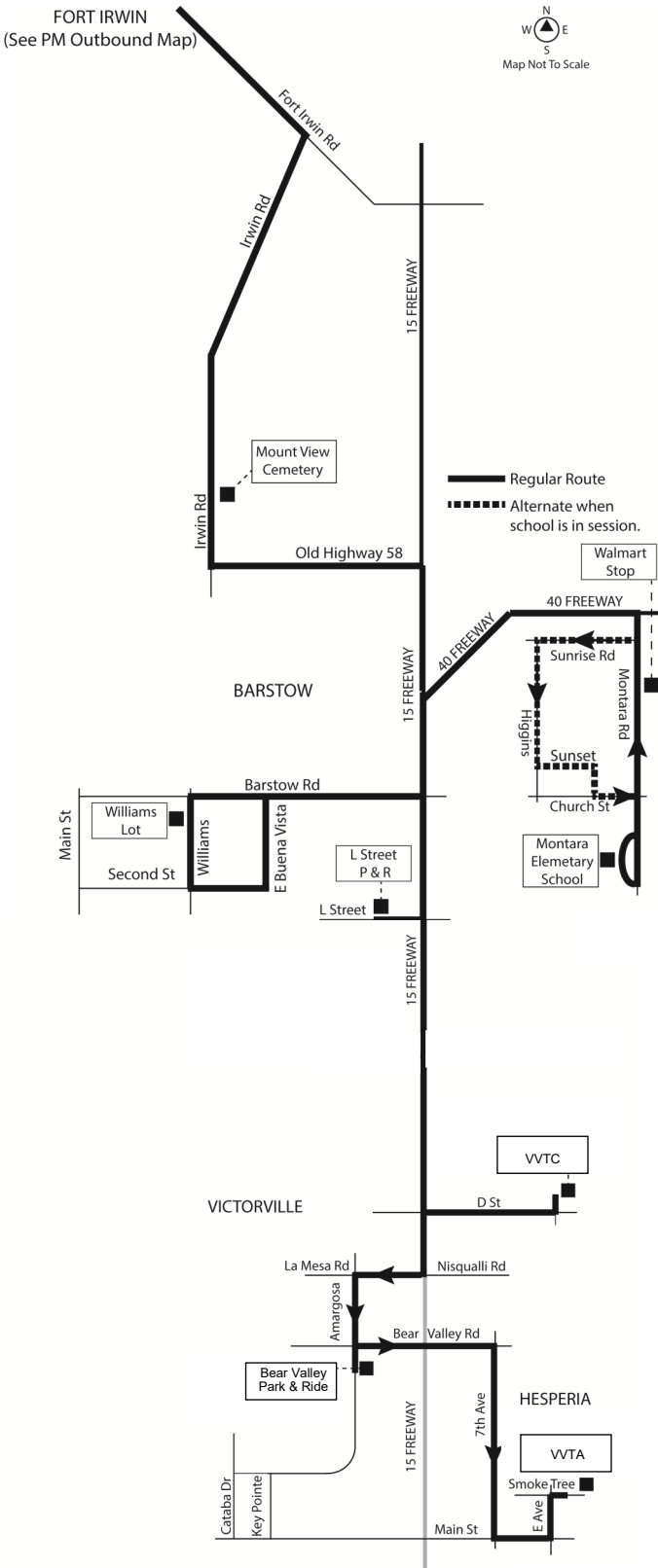

LINE 118: FORT IRWIN - HESPERIA



LINE 118: FORT IRWIN - HESPERIA

PULL IN/PULL OUT ROUTES

TO FORT IRWIN BUS LOT:

Hesperia Division via Smoke Tree, (L) E Ave, (R) Main St, (R) 3rd Ave, (R) Yucca St, (L) Hesperia Rd, (R) D St, (L) Stoddard Wells Rd, (L) 15 Freeway North, (R) Fort Irwin Rd exit, (L) Fort Irwin Rd, (R) Ammo Route (Ammo Route will parallel Fort Irwin Rd, and will go back into Fort Irwin Rd), stay to left side for buses as entering Fort Irwin, continue into South Loop Rd, (L) Inner Loop, (R) G Ave, (R) Second St, (L) into 1st driveway of bus lot.

L STREET PARK & RIDE TO FORT IRWIN BUS LOT:

From L Street Park & Ride, (L) L St, (L) 15 Freeway North, (R) Fort Irwin Rd exit, (L) Fort Irwin Rd, (R) Ammo Route (Ammo Route will parallel Fort Irwin Rd, and will go back into Fort Irwin Rd), stay to left side for buses as entering Fort Irwin, continue into South Loop Rd, (L) Inner Loop, (R) G Ave, (R) Second St, (L) into 1st driveway of bus lot.

DESTINATION SIGN CODES:

TERMINAL	DISPLAY	CODE
Smoke Tree & E Ave	118 Hesperia	1182
	Sorry, Not In Service	101